

ASC670 5-500 MHz. Cascadable Amplifier

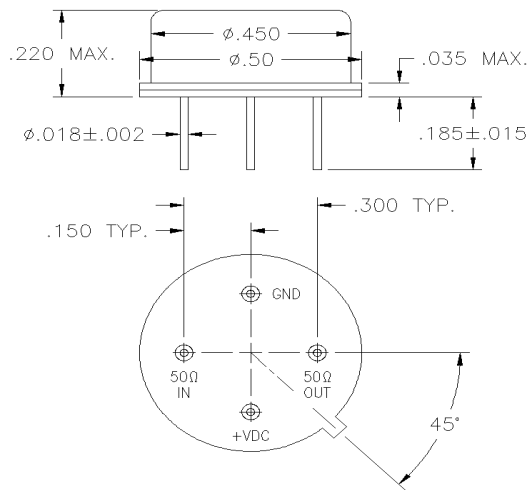

Features: (typical values)

- Medium Noise Figure 3.0 dB.
- High Output Power +25.0 dBm.
- High Reliability
- Hermetic Package (Surface mount available)
- No external components required

Specifications (Referenced to 50 ohms)

Parameter	Typical Value	Min. Value	Max. Value	Units
Frequency		5	500	MHz.
Gain	15.7	15.0		dB.
Gain Flatness	± 0.5		± 1.0	dB.
Gain Var. over temp.	0.6			Δ dB.
Pout @ 1dB. Comp.	+25.0	+21.0		dBm.
Noise Figure	3.0		5.5	dB.
Reverse Isolation	20.0			dB.
IP ₃ /IP ₂ (two-tone)*	37/46	33/43		dBm.
HIP ₂ (2 nd harm.)	48			dBm.
VSWR In/Out	1.7:1		2.0:1	
Supply Req'd	+15/120		+15/130	v/mA.

Min. and max. values are from -55°C to +85°C

*IP₃ and IP₂ are in band output intercept points

Maximum Ratings

Storage Temperature -62°C to +125°C
 DC Voltage +17 volts
 RF Input Power +13.0 dBm.
 Case Temperature +95°C

Typical Performance Curves

- ■ - -55°C - ◆ - +25°C - ▲ - +85°C

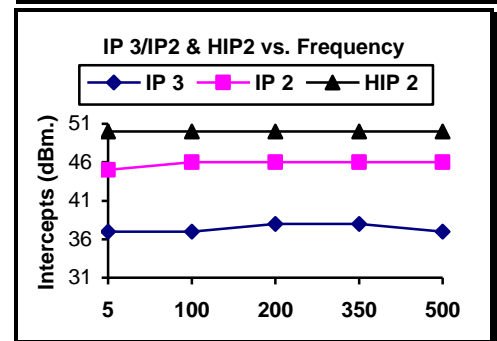
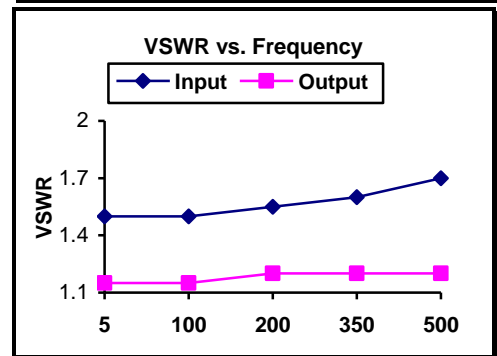
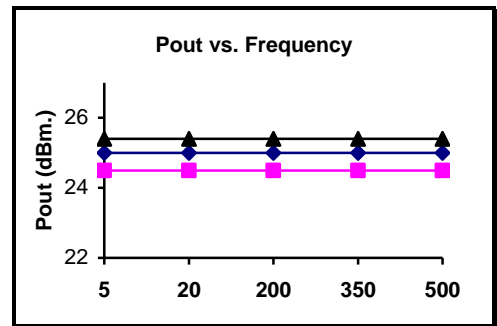
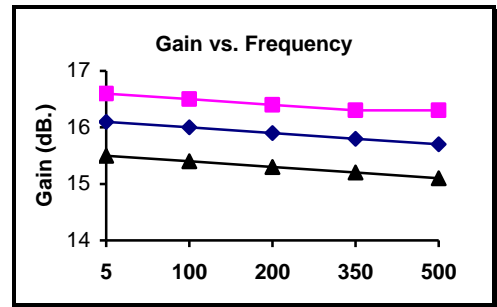

FUNCTIONAL BLOCK DIAGRAM

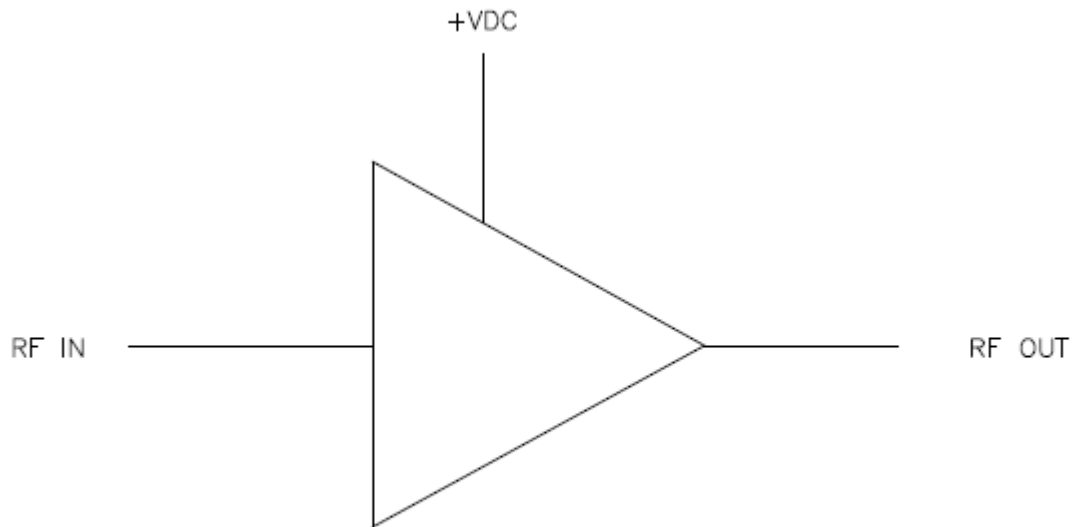

NO EXTERNAL COMPONENT REQUIRED