

Features: (typical values)

- Output Power – .. 23dbm. @ 1dB. compression,
- NF..... 2.5 dB.
- GAIN 42 dB.
- Unconditional Stability
- No external components required

**2000-8000 MHz
Casscade Amplifier**



Maximum Ratings

Storage temperature -55°C to +125°C
 DC Operating Voltage +15.0 volts
 RF Input Power +30dBm. Max.
 Operating Base Temp. 0 to +65°C
 No damage Temp -62°C to +85°C

Specifications @ Tcase = 25°C, Vcc = 15V, 50 ohm systems unless otherwise noted.

Parameter	Typical Conditions	Min Value	Max Value	Units
Frequency Range		2000	8000	MHz.
RF Gain	42	40	44	dB.
Gain Flatness	±0.7		±1.0	dB.
Input VSWR	1.8		2.0:1	-
Output VSWR	1.8		2.0:1	-
Reverse Isolation	45.0			dB
Noise Figure	2.5		3.0	dB.
Power Output- 1dB Compression	24	23		dBm.
IP3 @ 3 & 13 dBm per tone	34	33		dBm.
Second Order Intercept (IP2) @ 3 & 13 dBm per tone	45	43		dBm.
RF Input Power			30	dBm.
Supply Current @ 15 Volts	600		650	mA.
Operating Temperature 0 to +65C				

2-56 X .09
MIN THD
4 PL FAR SIDE

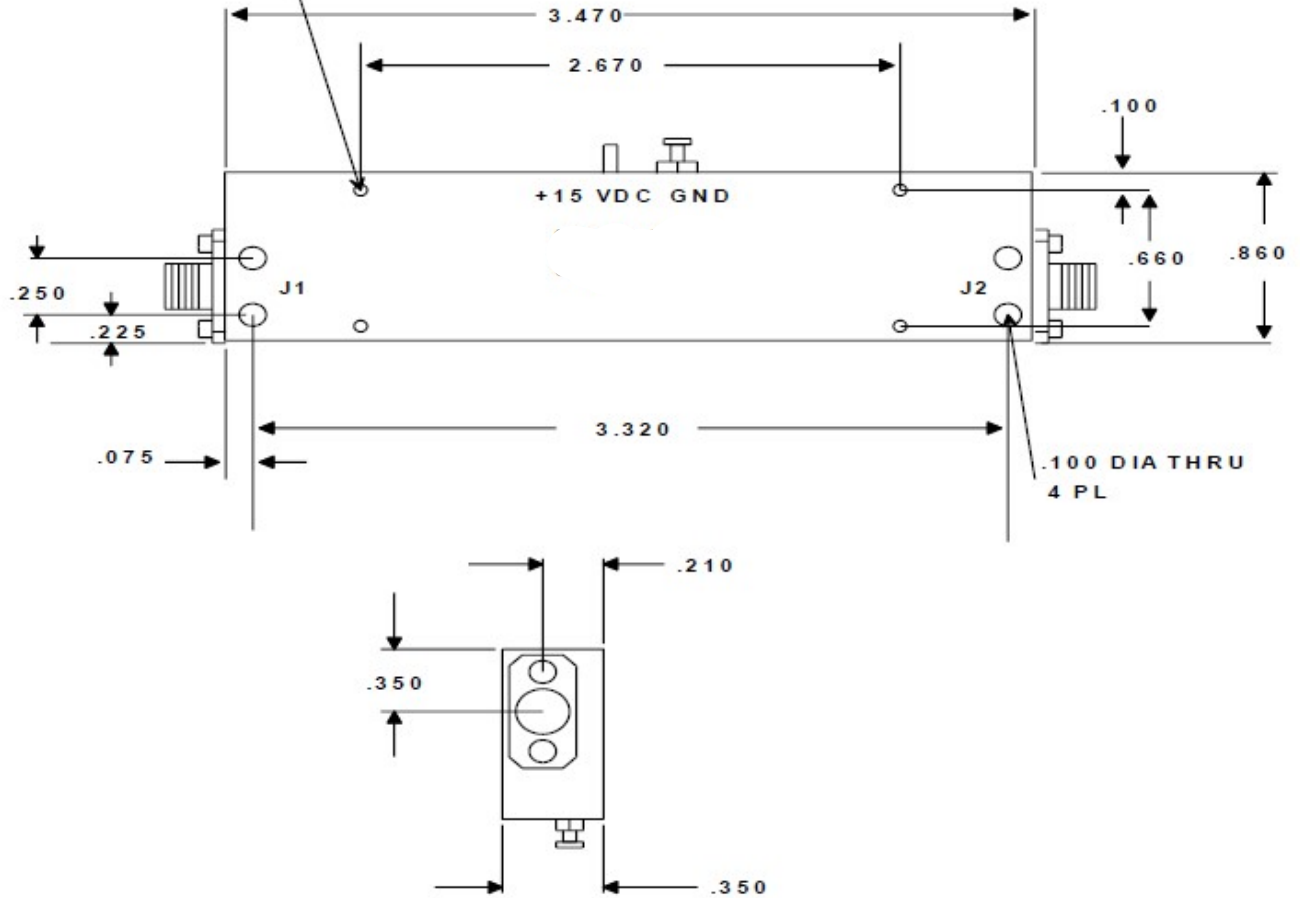

FUNCTIONAL BLOCK DIAGRAM

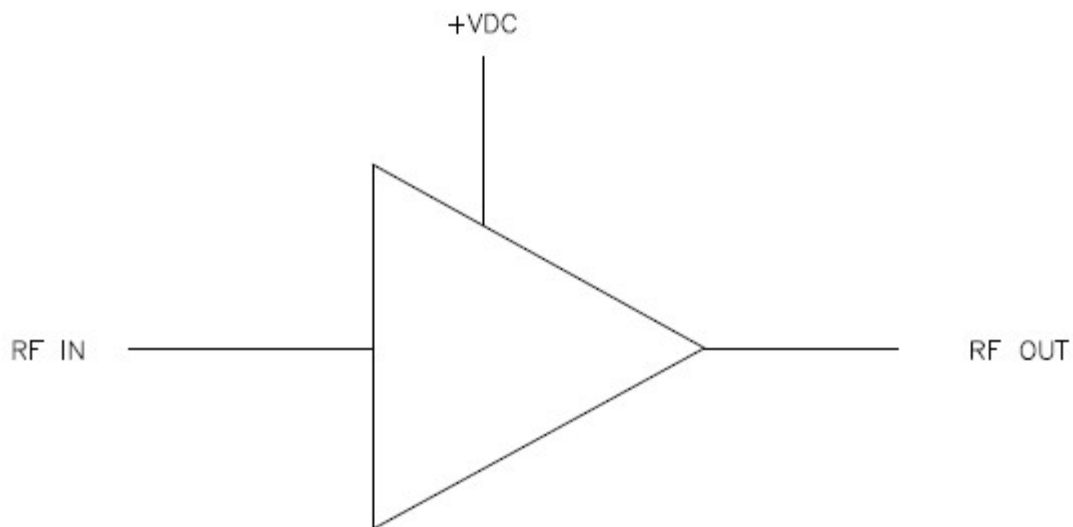

NO EXTERNAL COMPONENT REQUIRED